

# Dockplate Options

## Standard

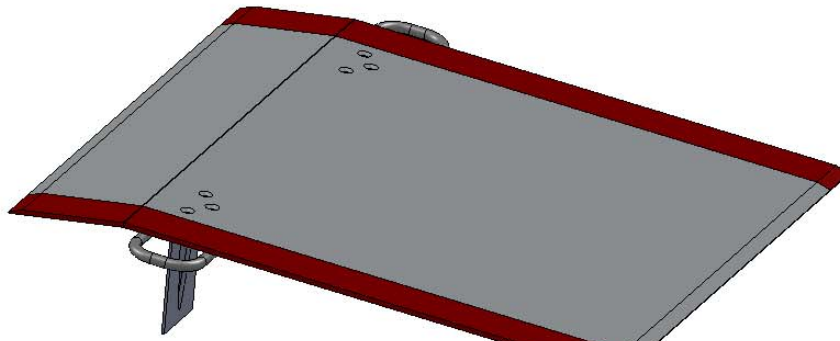

### Standard Dockplates features:

- Anti-slip treadplate finish
- Crowned (10°) & bevelled for smooth operation
- Loop type handles for easy movement
- One pair of locking legs to prevent movement
- Painted side guidelines

## Side Curbs & Castors (SCC-2)

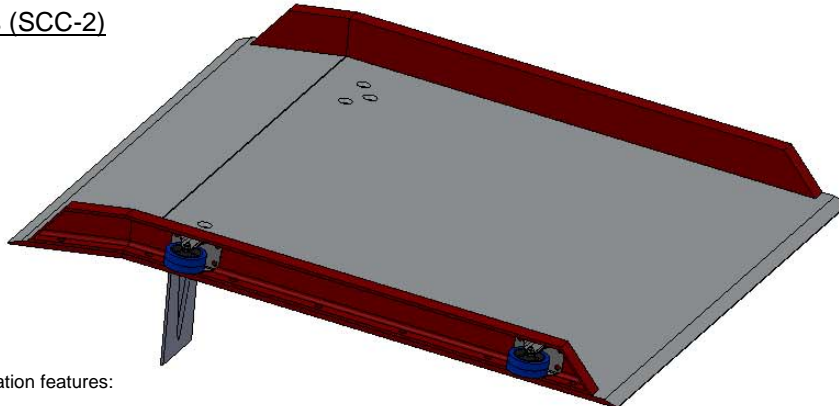

### Side Curbs & Castors modification features:

- 75mm safety side rail
- Castors fitted to aid movement
- Loop handles removed

## Fork Truck Lifting Handles (FTH-1)

### Forktruck Lifting Handles modification features:

- Handles are placed through slots in plate, and rotated 90° for movement with FLT.
- Once the plate is in position, the handles are stored over the loop type lifting handles.
- Handles secured to plate with chain to prevent separation/loss.

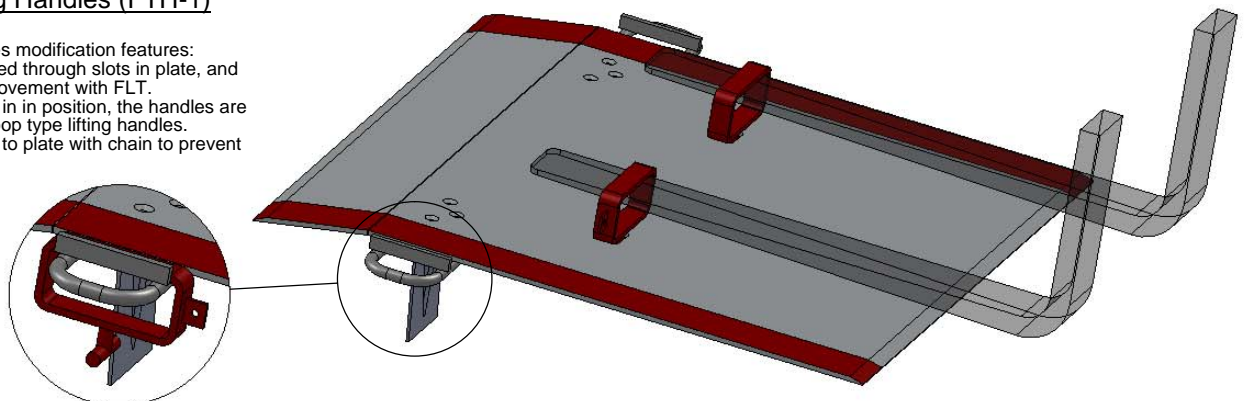

Handle in stored position.

Note: Securing chains omitted for clarity.

## Fixed Span Locking Legs (FSL-1)

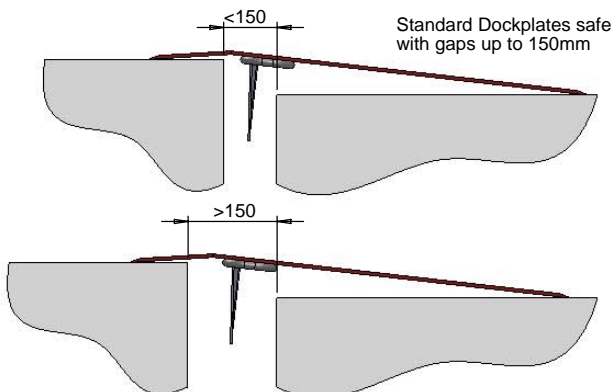

Standard Dockplates safe with gaps up to 150mm

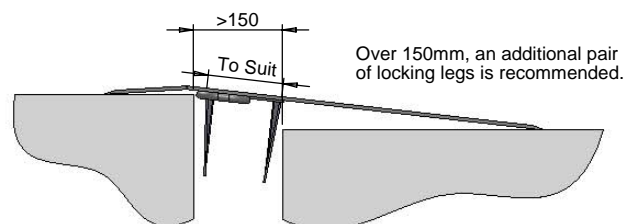

Over 150mm, an additional pair of locking legs is recommended.

Over 150mm, there is significant risk of the plate separating from vehicle - this is not recommended.



Contact us now for assistance selecting the correct equipment for your application.